



Offers In Excess Of £285,000

3 Bedroom Semi-Detached House for sale  
94 Victoria Avenue, Worcester





## Overview

Unexpectedly back on the market is this charming and meticulously maintained late Victorian property in the heart of Worcester. Through its modernisation has kept many sought-after period features have been retained.



## Key Features

- Island Kitchen with granite worktops
- Log Burner
- Victorian Period Features
- Open Plan Kitchen/Dining
- Original Wooden Floors
- High Ceilings
- Enclosed Garden
- Original Fireplaces
- Double Glazed
- Gas Central Heating







Unexpectedly back on the market is this charming and meticulously maintained late Victorian property in the heart of Worcester. Through its modernisation has kept many sought-after period features have been retained.

With its stunning original woodwork, high ceilings, and grand bay windows, the inviting living spaces are filled with natural light. The original Victorian staircase leads you from the road into a beautiful stained glass hallway, which is very spacious and decadent indeed.

With Brickbond tiling and a roll top bath, this bathroom is a place where classic elegance meets modern comfort. You are greeted by two spacious bedrooms one of which is the master bedroom with a stunning original fireplace. The third bedroom is currently being used as an office but would make a substantial single bedroom.

Fitted with an island kitchen, open plan dining and log burner. The original wooden floors and French doors lead you onto a well sized mature garden which provides a beautiful family home for the 21st century.

Ideally located with local shops, parks, and schools just minutes away, this Victorian gem is a rare find! Don't miss the opportunity to call this enchanting home your own. Ewe can book now to view!



**Kitchen / Dining Room**  
16' 0" x 15' 3" (4.90m x 4.67m)

**Lounge**

14' 2" x 10' 0" (4.32m x 3.05m)

**Bedroom 1**

15' 3" x 10' 1" (4.65m x 3.09m)

**Bedroom 2**

12' 1" x 10' 1" (3.70m x 3.09m)

**Bedroom 3**

8' 5" x 5' 11" (2.58m x 1.82m)

**Family Bathroom**

8' 11" x 5' 11" (2.73m x 1.82m)

# Floorplans

GROUND FLOOR  
440 sq.ft. (40.9 sq.m.) approx.

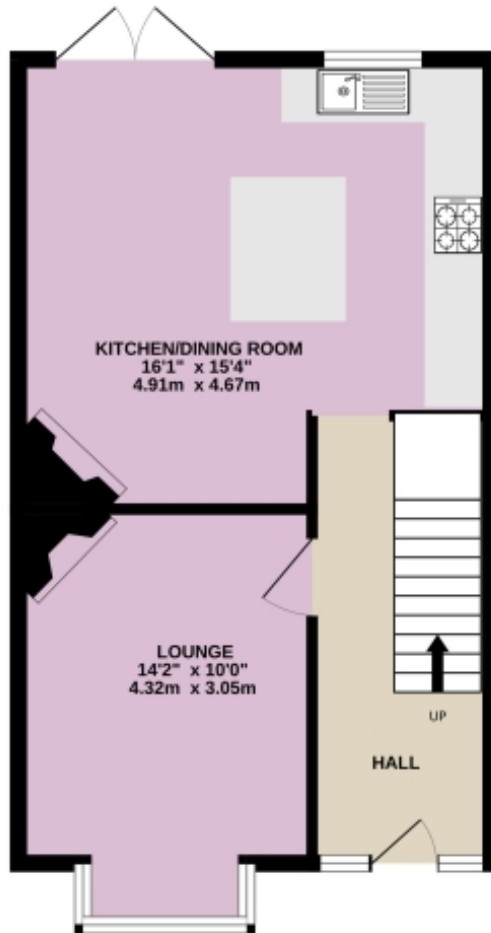

1ST FLOOR  
434 sq.ft. (40.3 sq.m.) approx.

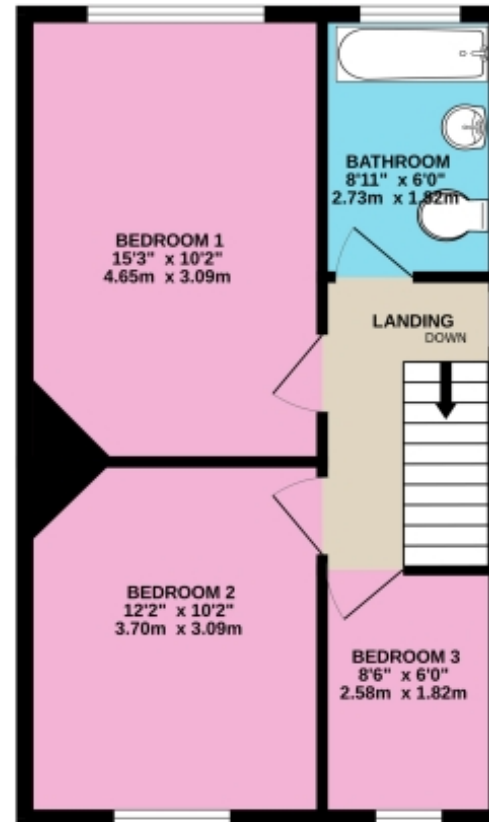

3 BEDROOM SEMI DETACHED VICTORIA AVENUE

TOTAL FLOOR AREA : 873 sq.ft. (81.1 sq.m.) approx.

Whilst every attempt has been made to ensure the accuracy of the floorplan contained here, measurements of doors, windows, rooms and any other items are approximate and no responsibility is taken for any error, omission or mis-statement. This plan is for illustrative purposes only and should be used as such by any prospective purchaser. The services, systems and appliances shown have not been tested and no guarantee as to their operability or efficiency can be given.

Made with Metropix ©2024



# Floorplans

GROUND FLOOR  
440 sq.ft. (40.9 sq.m.) approx.

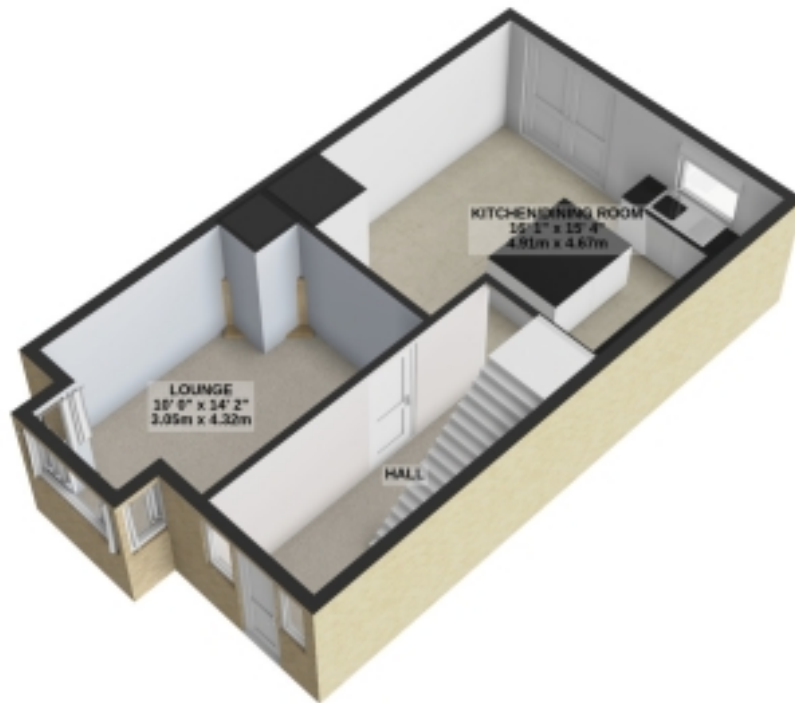

1ST FLOOR  
434 sq.ft. (40.3 sq.m.) approx.

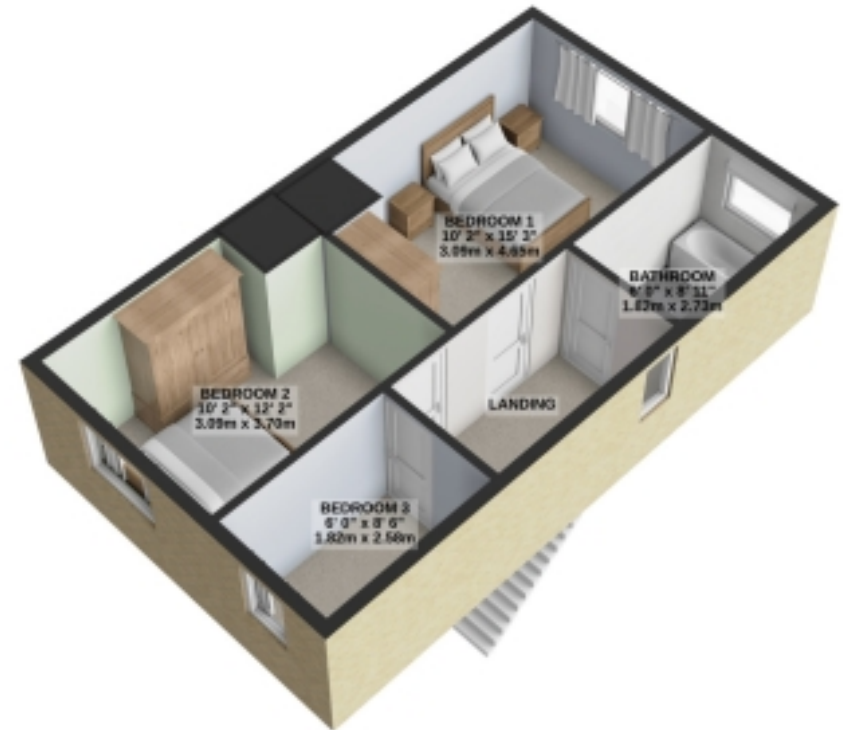

3 BEDROOM SEMI DETACHED VICTORIA AVENUE  
TOTAL FLOOR AREA : 873 sq.ft. (81.1 sq.m.) approx.

For illustrative purposes only. Decorative finishes, fixtures, fittings and furnishings do not represent the current state of the property. Measurements are approximate. Not to scale.  
Made with Metropix © 2024



# Floorplans

GROUND FLOOR



3 BEDROOM SEMI DETACHED VICTORIA AVENUE

Whilst every attempt has been made to ensure the accuracy of the floorplan contained here, measurements of doors, windows, rooms and any other items are approximate and no responsibility is taken for any error, omission or mis-statement. This plan is for illustrative purposes only and should be used as such by any prospective purchaser. The services, systems and appliances shown have not been tested and no guarantee as to their operability or efficiency can be given.  
Made with Metropix ©2024



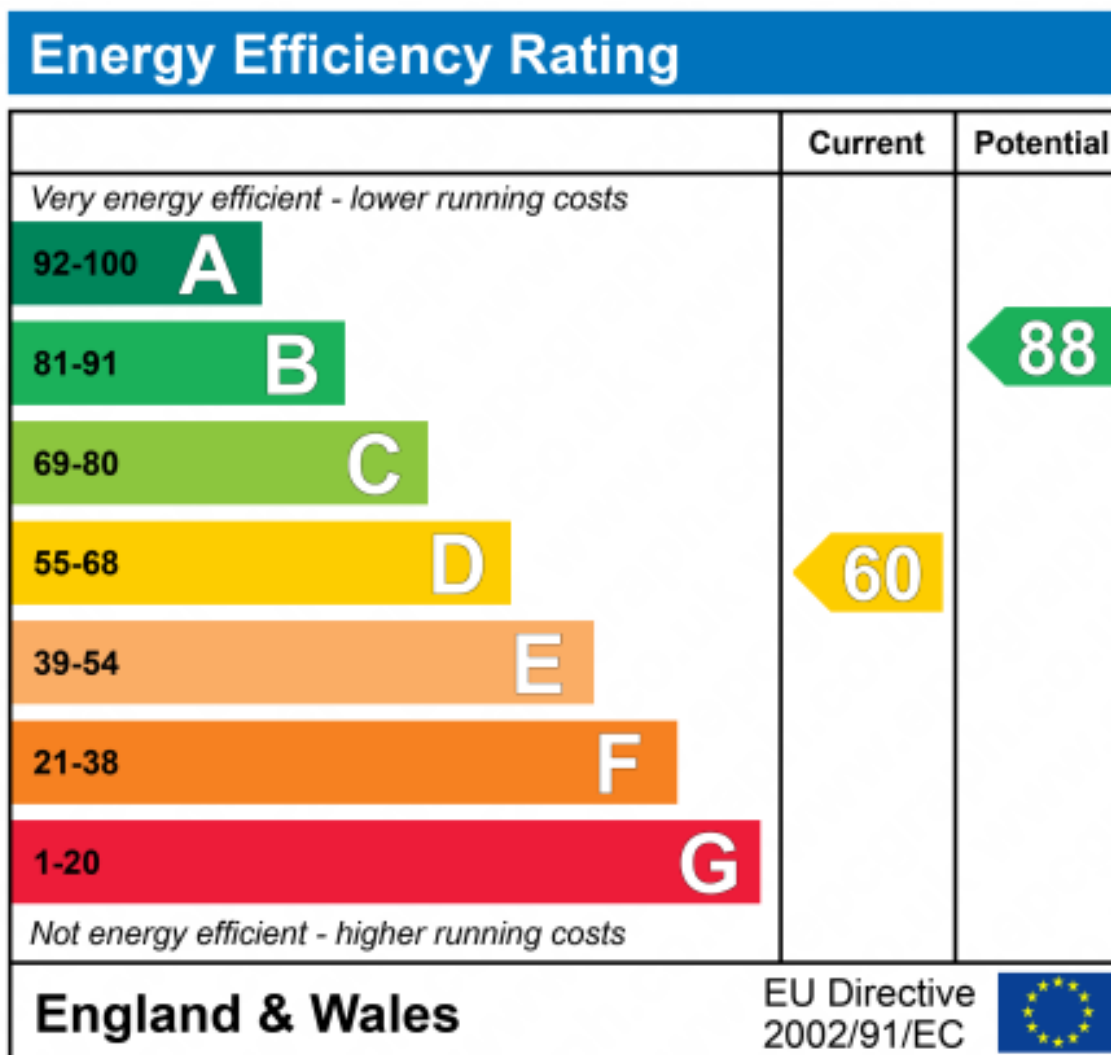



Marketed by EweMove Worcester East

01905 967991 (24/7)

worcestereast@ewemove.com



**EweMove**  
SALES AND LETTINGS